

9510 Endeavor Drive SE

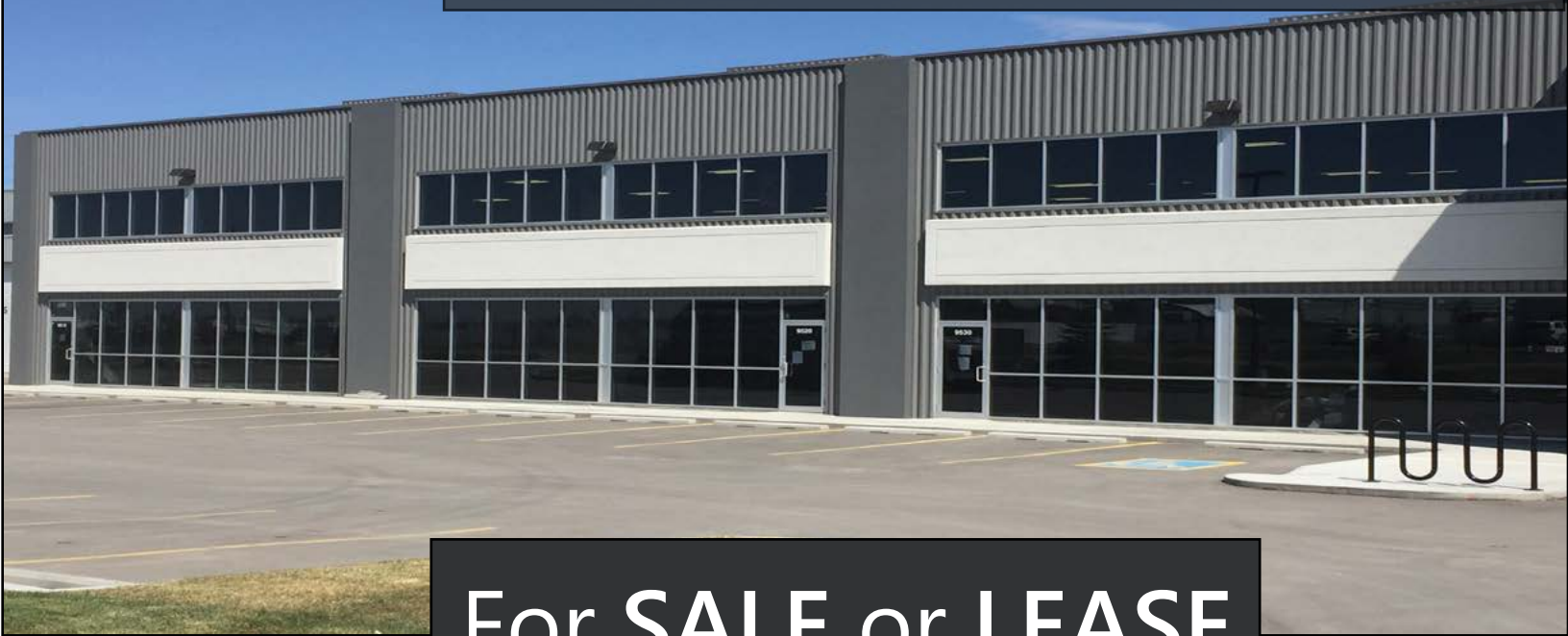

For SALE or LEASE

Property Features

Size:	5,070 sq.ft.
Yard:	+/- 6,440 sq.ft. of privated fenced yard storage
Loading:	2 Drive-In Doors
Power:	200 Amp
Heating:	Forced Air
Ceiling:	22'
Zoning:	DC-56
Features:	Sumps Crane Capable
Asking Rate:	Market
Asking Price:	Market
Taxes:	\$3.14/sq.ft.(2017)
Location:	Shepard Industrial Park

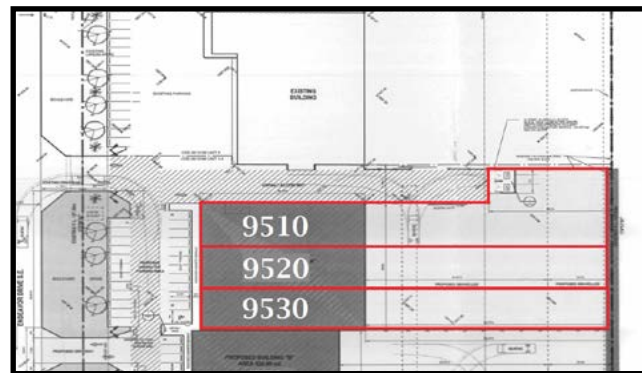

Lease to Own Opportunity!

CMS Real Estate Ltd.

#200, 136- 17 Ave NE Calgary, AB T2E 1L6
403-291-0425 www.cmsrealestateltd.com



Gerry Macdonald
Broker, CCIM
403-291-0425
gm@cmsrealestateltd.com

John Hamilton
Associate
403-815-9041
hamilton.jw@hotmail.com

Gerry Macdonald
Associate Broker
403-219-0161
gmjr@cmsrealestateltd.com

Jessica Macdonald
Associate
403-219-0155
jessica@cmsrealestateltd.com

"The information contained herein is believed to be true but does not form part of any future contract. The property is subject to sale, withdrawal or price change without notice."
The information contained herein is based upon the information furnished by the principal sources, which we deem reliable - for which we cannot assume responsibility, but which we believe to be correct.